



ISOTRA BASIC SOLAR MOTOR

with integrated receiver
for screen and exterior roller blinds



CONTENTS

1. PRIOR INFORMATION

1.1. Field of application

2. INSTALLATION

2.1. Caution

2.2. Motor preparation

2.3. Tube preparation

2.4. Motor assembly

2.5. Tube assembly

3. ASSEMBLY CONFIGURATION

4. SET INSTRUCTIONS

4.1. Power on/off and pair with remote

4.2. Set end limits

4.3. Set favorite limit

4.4. Adjust end limit

4.5. Delete end limit

4.6. Disable/enable rebound function

4.7. Adjust sensitivity

4.8. Copy remote

4.9. Delete remote

4.10. Restore the factory

5. OPERATION

5.1. Up/down operation

5.2. Up/down/favorite operation

5.3. Obstacle detection

5.4. Anti-freezing protection

5.5. Recalibrate End-stop positions

6. APP OPERATION

7. TECH DATA

8. TROUBLE SHOOTING

1. PRIOR INFORMATION

Please read these instructions carefully before installing and using the motor. The motor must be installed by a motorization and home automation professional. The motor is designed for use in dry rooms and should not be exposed to direct weather conditions. Failure to comply with this instruction may result in injury or death. It is prohibited to use the motor outside the field of application described above. If in doubt when installing the motor, or to obtain additional information, contact a A-OK adviser or go to the website www.a-okmotor.com.

1.1. Field of application

This product is specially designed to all types of roller shutters to fit onto windows, the roller shutter must be fitted with rigid links and end stops, it has special functions of obstacle detection and anti-freeze protection.

2. INSTALLATION

2.1. Caution

Please read these instructions carefully before installing and using this product.



Forbid water penetration



Never drop and knock the motor



Never drill and ruin the motor



Always make a loop on power cable



Never contact with corrosives

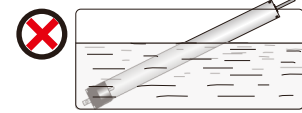

Never immerse into water

2.2. Motor preparation

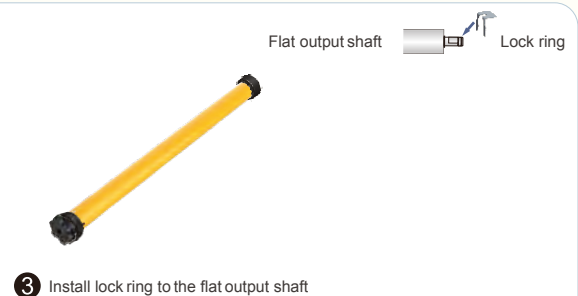
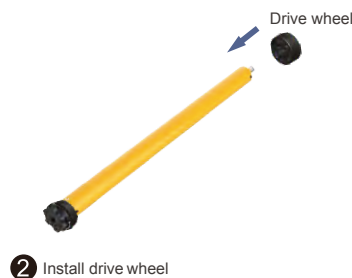

2.3. Tube preparation

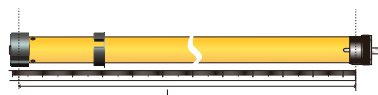

Measure the length to drill for round smooth tube

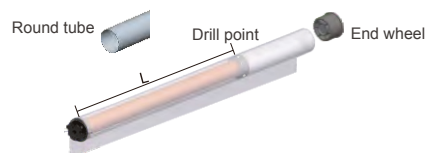

Marked drill position on the tube, and insert end wheel

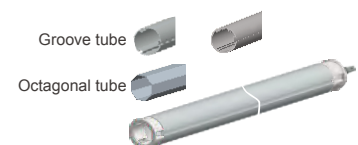

Installation of groove tube and Octagonal tube without drill

2.4. Motor assembly



1 Slide the motor into the roller tube

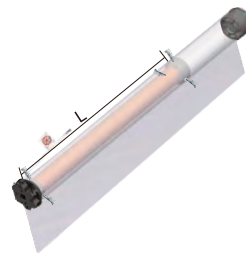

2 Fix the roller tube on the motor wheel using the screws

2.5. Tube assembly

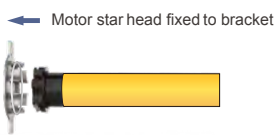

Motor star head fixed to bracket

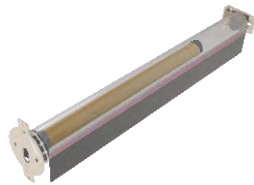

Installing the motor/tube assembly



Keep horizon after assembly

3. ASSEMBLY CONFIGURATION

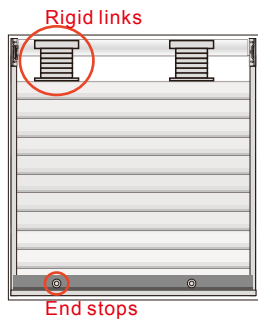

Application 1:
Setting end limit refer: 4.2.1 or 4.2.2

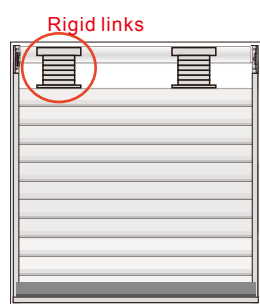

Application 2:
Setting up limit refer: 4.2.3
Setting down limit refer: 4.2.2

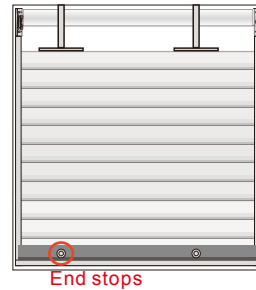

Application 3:
Setting up limit refer: 4.2.2
Setting down limit refer: 4.2.3

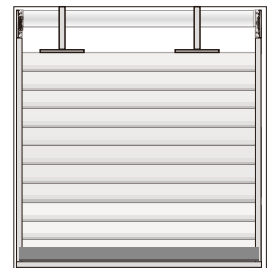

Application 4:
Setting end limit refer: 4.2.3

Note:

In order to work properly in obstacle detection:

- Should use spring lock device on tube



- Should use lock block in the side rail or end rail



- Choose proper motor torque according to shutter weight(Nm)
- Set up and down end limits

4.SET INSTRUCTION S

4.1 Power on/off and pair with remote

Power on/off

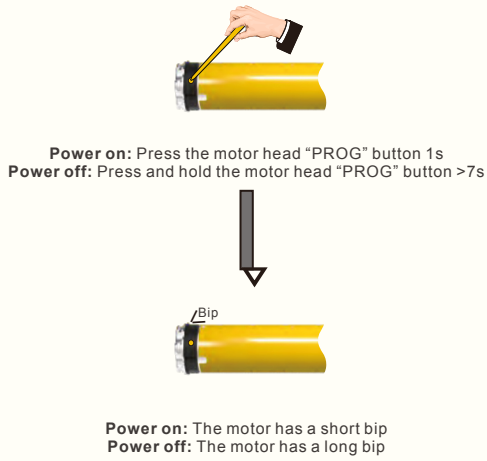

Pair with remote

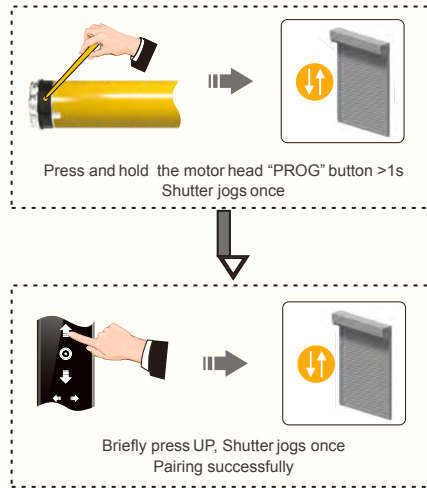

4.2 Setting end limits

4.2.1 Automatically setting end limits

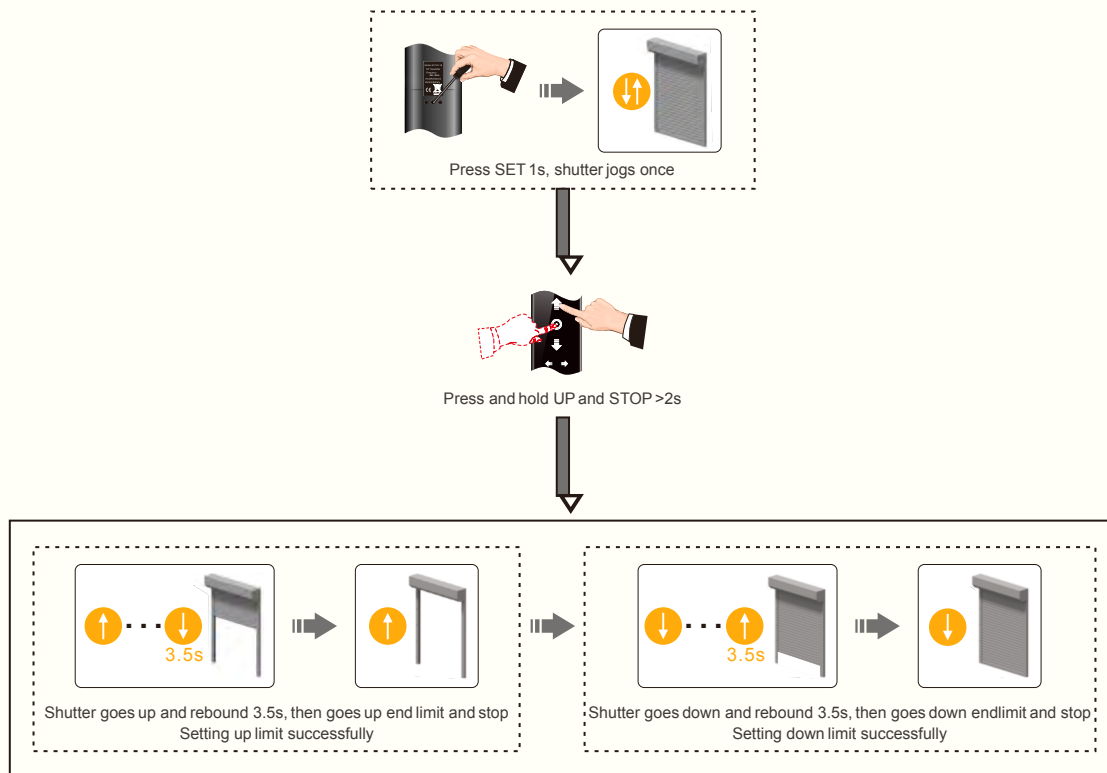

ISOTRA BASIC SOLAR MOTOR

4.2.2 Semi-automatically setting end limits

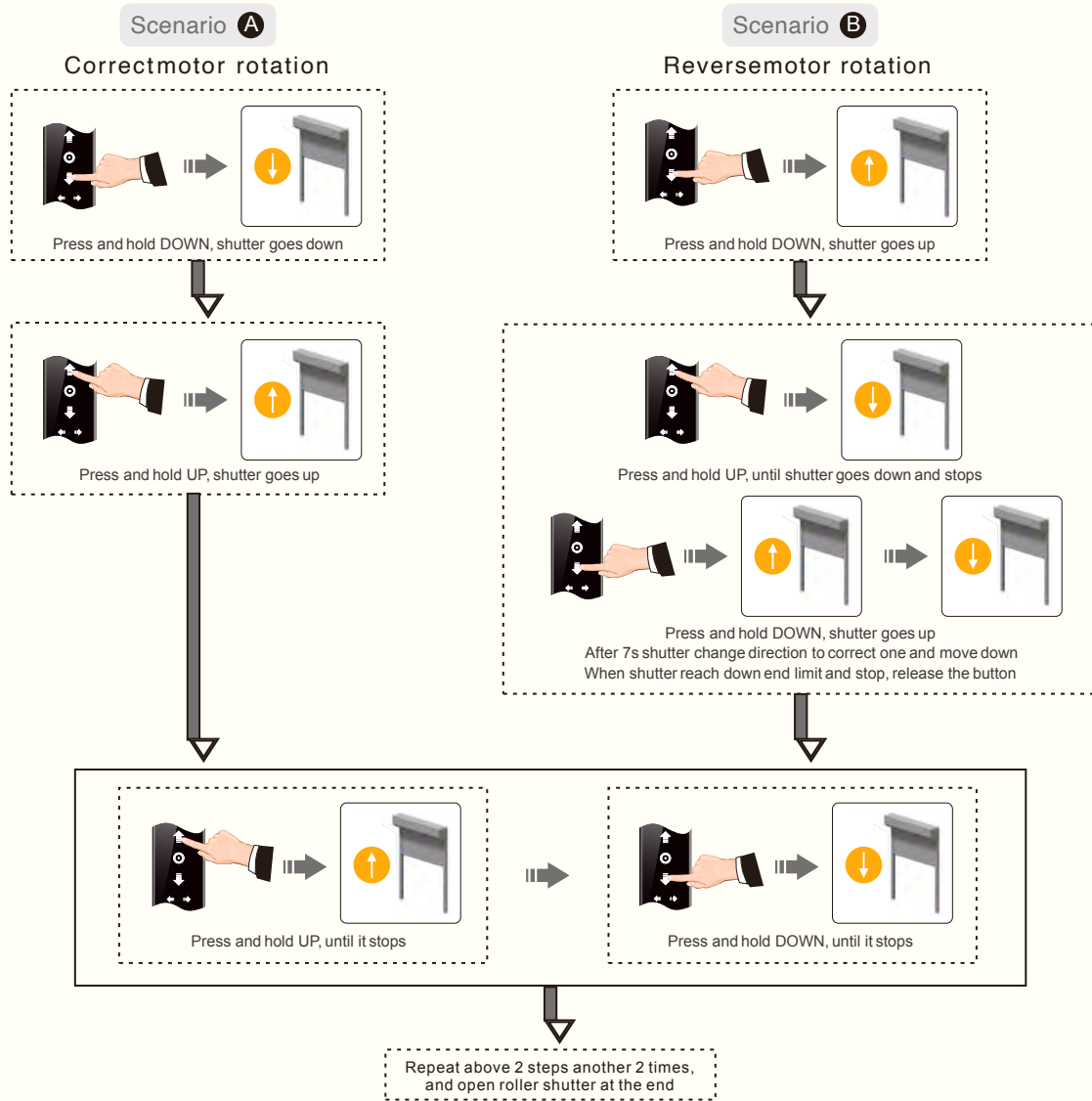

4.2.3 Manually setting end limits

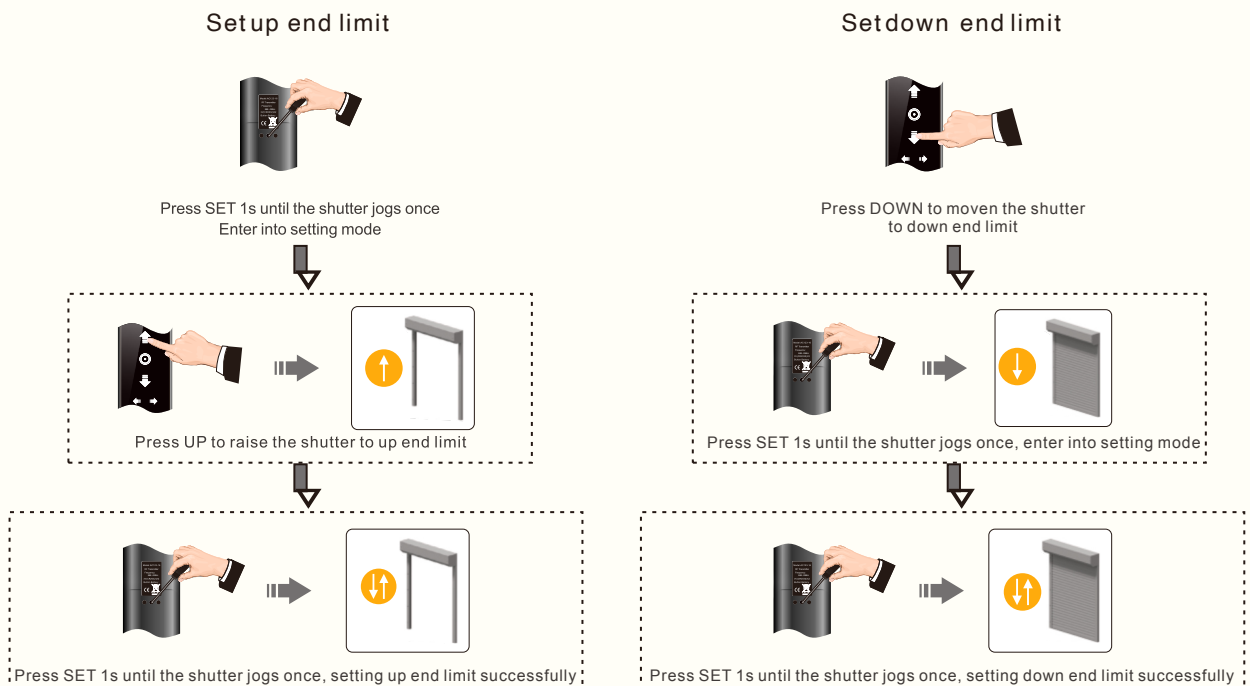

4.3 Set favorite limit



Press UP/DOWN moves to desired favorite limit

Press SET (1s), until the shutter jogs once
Press SET (1s) again, until the shutter jogs once
Set favorite limit successfully

4.4 Adjust end limits



Shutter moves to end limit to be readjusted
Press SET 1s until the shutter jogs once

Shutter moves to new desired end limit
Press SET 1s until the shutter jogs once
Adjust end limits successfully

4.5 Delete end limits



Press and hold SET >7s
Shutter jogs once at 1s

Remarks:
1. Delete single limit at end limit point position
2. Don't delete all limits at end limit point position
3. The first end limit can't be deleted

Delete single limit: Shutter jogs once at 7s
Delete all limit: Shutter jogs twice at 7s
Delete end limits successfully

4.6 Disabled/enabled rebound function



Press and hold UP and DOWN 3s simultaneously
Shutter jogs once

Enable rebound: Press UP 1s, shutter jogs once
Disenable rebound: Press DOWN 1s, shutter jogs once

4.7 Adjust sensitivity



Press and hold UP and DOWN >5s simultaneously
Shutter jogs once at 3s and jogs once at 5s

Default Sensitivity: 3
Sensitivity Range: 1-5

Press and hold UP and STOP >2s simultaneously, sensitivity: +1
Press and hold DOWN and STOP >2s simultaneously, sensitivity: -1
Press and hold STOP >2s simultaneously until shutter jogs once
Adjust sensitivity successfully

4.8 Copy remote



Paired remote: Press and hold STOP >5s
Shutter jogs once

New added remote: Press UP 1s, shutter jogs once
Copy remote successfully

4.9 Delete remote



Press and hold STOP >5s, Shutter jogs once



Press SET 1s, shutter jogs once
Delete remote successfully

Method A



Press and hold STOP >5s, shutter jogs once

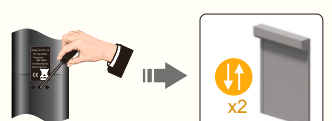

Press and hold SET >7s
Shutter jogs once at 1s and jogs twice at 7s
Restore the factory successfully

Method B



Briefly press the motor head "PROG" button two times
The motor have bip twice

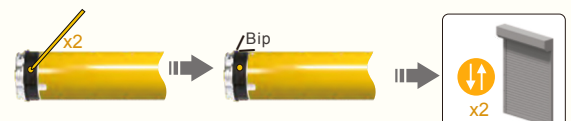

Press and hold the motor head "PROG" button (>3s) two times
The first press: the motor have a bip once; The second press: the shutter jogs twice
Restore the factory successfully

4.10 Restore the factory

Note: This procedure deletes all remotes, sensors, end limits

5. OPERATION

5.1 Up/down operation

A Up operation



Press and hold UP



Shutter goes up end limit

B Down operation



Press and hold DOWN



Shutter goes down end limit

5.2. Up/down/favorite operation

5.2.1 Lower the roller shutter

Method A



Press and hold DOWN



Shutter goes favorite limit



Press and hold DOWN again



Shutter goes down end limit

Method B



Press DOWN (<1s) twice



Shutter goes down end limit directly

5.2.2 Raise the roller shutter

Method A



Press and hold UP

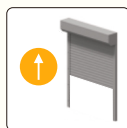

Shutter goes favorite limit



Press and hold UP again



Shutter goes up end limit

Method B



Press UP (<1s) twice



Shutter goes up end limit directly

5.3 Obstacle detection

A Rebound disabled



Shutter goes down to detects resistance



Shutter stops

B Rebound enabled



Shutter goes down to detects resistance



Shutter rebounds up for 3.5s

5.4 Anti-freezing protection



Shutter detects resistance



Shutter stops

5.5 Recalibrate End-stop positions

A Up

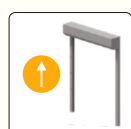

Shutter goes up end limit

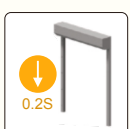

Shutter rebounds down for 0.2s

B Down



Shutter goes down end limit



Shutter stops

Note: Shutter will reset end limits by executing A→B→A→B after every 100 up and down cycles runs
This function is cleared after factory setting
This feature applies to the Application1 assembly configuration

6. APP OPERATION



1) Scan the QR code to download APP.

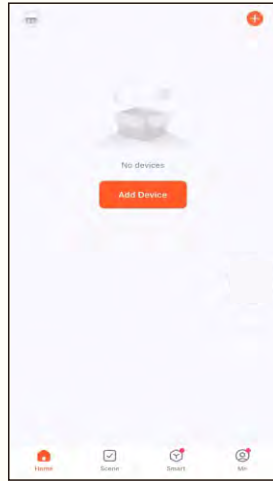

2) On the page "Home", choose "Add a device" or click "+" at the upper right corner.



3) Add by automatic search or on this page click "Add Manually" — "Gateway control" — "Wireless Gateway(Zigbee)".



4) Choose network and type in password.



5) Adding devices.



6) Finish adding gateway, click "Done".

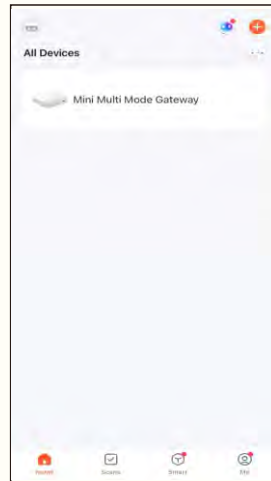

7) On the page "Home", click "Mini Multi Mode Gateway".

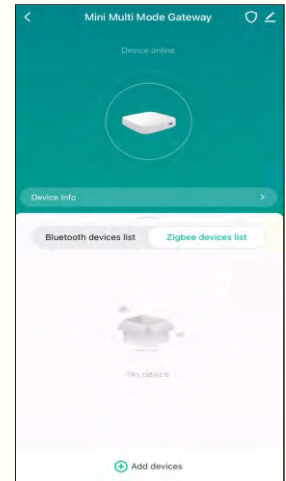

8) On the page click "Zigbee devices list" — "Add devices", to add motor.



9) Briefly press Pair-key 4 times, and long press it 3s (shutter jogs once at 1s, and jogs again at 3s), or press transmitter S2 3 times and shutter jogs once, then click "Next".



10) Click "Done", add motor successfully.

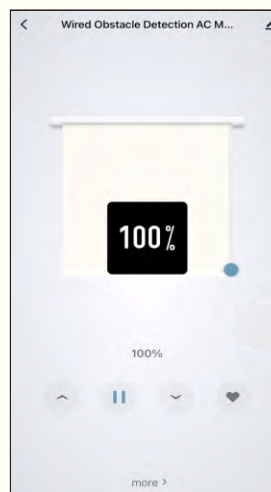

11) On the page to control device.

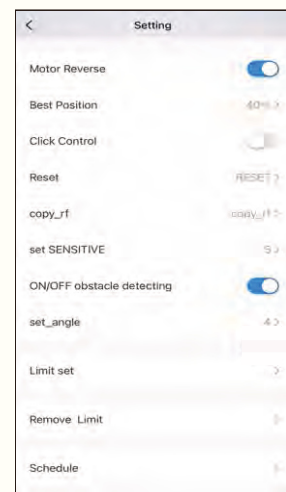

12) On the page to change the setting.

7. TECHDATA

Power supply	17V DC
Operating temperature	-20°C~+65°C
Control mode	RF/APP
Reception frequency	868.3MHz
Maximum continuous working time	5 Min
Protection level	IP65
Limit swiches	Electronic

8. TROUBLESHOOTING

Item	Problem	Reason	Solution
1	Motor doesn't run or runs slowly after power on	A. Wrong power supply B. Overload C. Inproper installation	A. Connect to rated power supply B. Change motor with proper torque to match the load C. Check installation of all parts
2	Motor stops in a sudden	A. Motor runs into over heat protection B. Power off C. Motor reaches end limits	A. Wait 5-10 minutes till motor cools down B. Power on C. Run in the opposite direction



In accordance with the provisions of the Directive of the European Parliament and of the Council 2012/19 / EU of 4 July 2012 on waste electrical and electronic equipment (WEEE), it is prohibited to place of used equipment together with other wastes, marked with crossed out wheeled bin symbol. The users are obliged to transfer their used equipment to a designated collection point for proper processing. The marking means, at the same time, that the equipment was put on the market after 13 August 2005. These legal obligations have been introduced to reduce the amount of waste generated from waste electrical and electronic equipment and to ensure an appropriate level of collection, recovery and recycling. The equipment does not contain any dangerous components, which would have any particularly negative impact on the environment and human health.



A-OK hereby declares that the drive covered by these instructions, when marked for input voltage 230V 50Hz and used as intended according to these instructions, is in compliance with the essential requirements of Directives 2014/53/EU declaration of conformity detailing standards and specifications used and stating all particulars for identification of the drive, name and address of the person(s) authorised to compile the technical file and empowered to draw up the declaration including place and date of issue can be contacted A-OK headquarters customer service at 0752-5717888.

